

Ref. No.	Part Number	Description	XS 1	XS 1B
0-1	306-14901-03-00	CARBURETOR ASS'Y, left.	1	1
0-2	306-14902-03-00	CARBURETOR ASS'Y, right. ...	1	1
1	256-14941-86-00	NOZZLE, main (Z-6)	2	2
2	93210-03142-00	O-RING	2	2
3	168-14190-15-00	VALVE SEAT ASS'Y (No. 1.5)	2	2
	168-14190-25-00	VALVE SEAT ASS'Y (No. 2.5)	2	2
4	256-14955-00-00	WASHER	2	2
5	256-14985-00-00	FLOAT	2	2
6	137-14186-01-00	PIN, float	2	2
7	256-14984-00-00	PACKING, float chamber ...	2	2
8	256-14981-00-00	BODY, float chamber	2	2
	256-14981-01-00	BODY, float chamber	2	2
9	256-14942-45-00	JET, pilot (No. 45)	2	2
	256-14142-42-00	JET, pilot (No. 42.5) (256-14942-42)	2	2
10	256-14944-24-00	JET, main (No. 120)	2	2
	256-14944-26-00	JET, main (No. 130)	2	2
	256-14944-28-00	JET, main (No. 140)	2	2
	256-14944-30-00	JET, main (No. 150)	2	2
11	256-14956-01-00	WASHER	2	2
12	256-14991-00-00	SCREW, plug	2	2
13	98501-04012-00	SCREW, pan head	8	8
14	92901-04100-00	WASHER, spring	8	8
15	256-14146-01-00	PLATE	2	2
16	256-14940-00-00	DIAPHRAGM ASS'Y	2	2
17	256-14916-19-00	NEEDLE	2	2
18	256-14919-00-00	CLIP	2	2
19	256-14946-00-00	PLATE for needle	2	2
20	256-14933-00-00	SPRING, diaphragm	2	2
21	256-14958-00-00	COVER, diaphragm	2	2
22	447-14926-00-00	BRACKET, throttle left	1	1
23	341-14927-00-00	BRACKET, throttle right (256-14927-00)	1	1

XS1 XS1B

CARBURETOR TYPE & MANUFACTURER	BS38 Mikuni	BS38 Mikuni
MAIN JET (M.J.)	130	130
AIR JET (A.J.)	-	1.2
NEEDLE JET (N.J.)	Z-6	Z-6
NEEDLE PLATE POSITION (N.P.)	IN19-A	IN10-A

	XS1	XS1B
PILOT JET (P.J.)	45	42.6
AIR SCREW (Turns out) (A.S.)	1	One turn out
STARTER JET (S.J.)	.6	.5

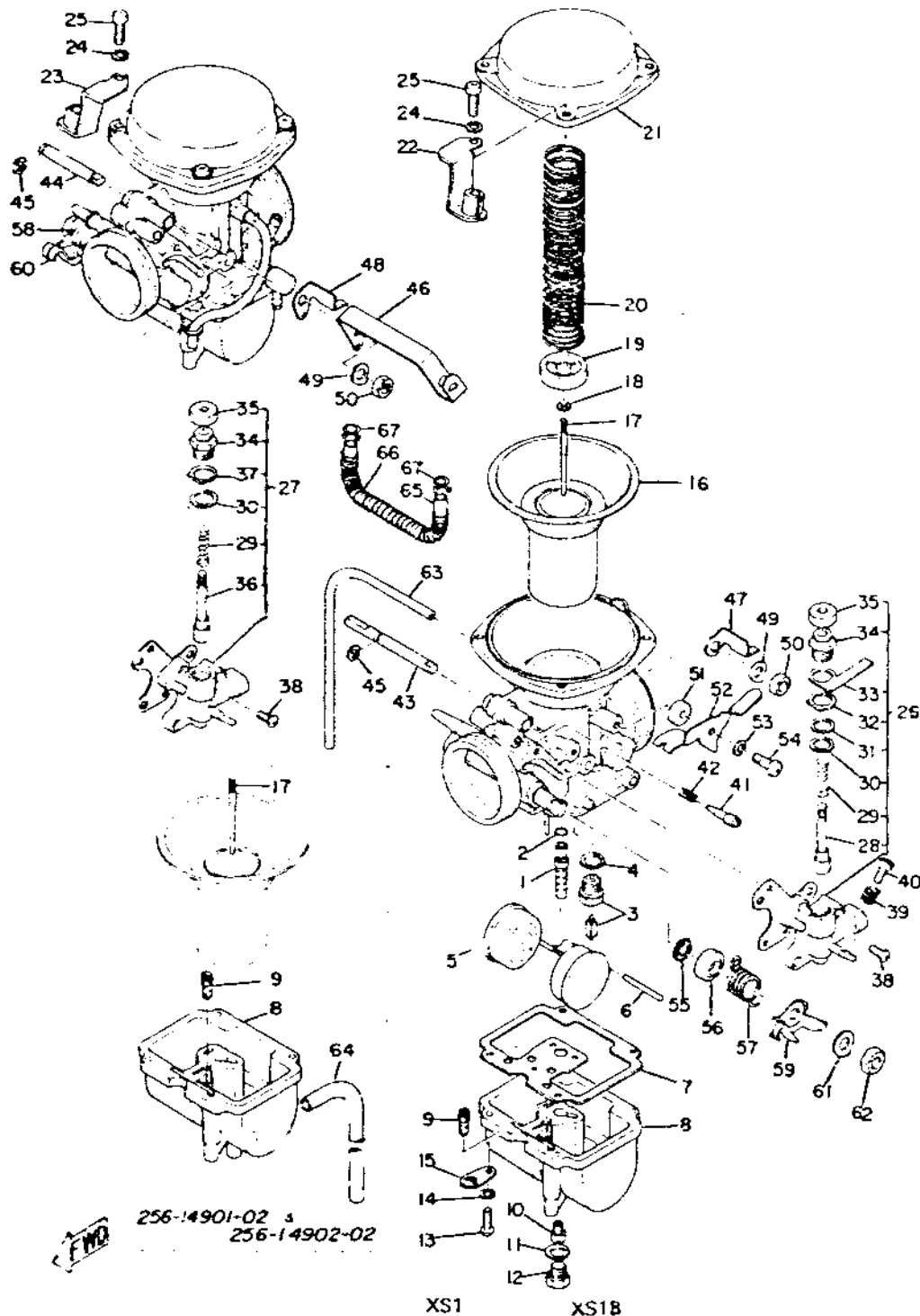

256-14901-02
256-14902-02

XS1 XS1B

Ref. No.	Parts No.	Description	XS1	XS1B/XS2/T X650
24	92903-05100-00	WASHER, spring	8	8
25	98503-05012-00	SCREW, pan head	8	8
26	256-14971-00-00	STARTER BODY ASS'Y, left	1	1
27	256-14972-00-00	STARTER BODY ASS'Y, right	1	1
28	256-14993-00-00	PLUNGER, starter	1	1
29	256-14135-00-00	SPRING, plunger	2	2
30	256-14954-00-00	WASHER	2	2
31	256-14995-00-00	BRACKET	1	1
32	256-14957-00-00	WASHER	1	1
33	256-14938-00-00	SPRING, set lever, starter	1	1
34	802-14174-00-00	CAP, plunger	2	2
35	802-14173-00-00	COVER, plunger cap	2	2
36	603-14171-00-00	PLUNGER, starter	1	1
37	256-14962-00-00	WASHER	1	1
38	98703-05010-00	SCREW, flat head	6	6
39	256-14934-01-00	SPRING, throttle stop	2	2
40	256-14922-01-00	SCREW, throttle stop	2	2
41	256-14923-00-00	SCREW, pilot	2	2
42	127-14134-00-00	SPRING, pilot screw	2	2
43	256-14977-00-00	SHAFT, starter left	1	1
44	256-14978-00-00	SHAFT, starter right	1	1
45	256-14937-00-00	CLIP	2	2
46	256-14974-00-00	LEVER, connector	1	1
47	256-14975-00-00	LEVER, starter left	1	1
48	256-14976-00-00	LEVER, starter right	1	1
49	256-14973-00-00	WASHER	2	2
50	95303-10700-00	NUT	2	2
51	256-14918-00-00	RING	1	1
52	256-14905-00-00	LEVER ASS'Y	1	1
53	92901-04100-00	WASHER, spring	1	1
54	98501-04012-00	SCREW, pan head	1	1
55	256-14997-00-00	SEAL	4	4
56	256-14969-00-00	CAP	2	2

XS1 XS1B

1. CARBURETOR TYPE & MANUFACTURER	BS38 Mikuni	BS38 Mikuni
MAM JET (M.J.)	13	130
AIR JET (A.J.)	-	1.2

PILOT JET (P.J.)	45	42.6
AIR SCREW (Turns out) (A.S.)	1	One turn out

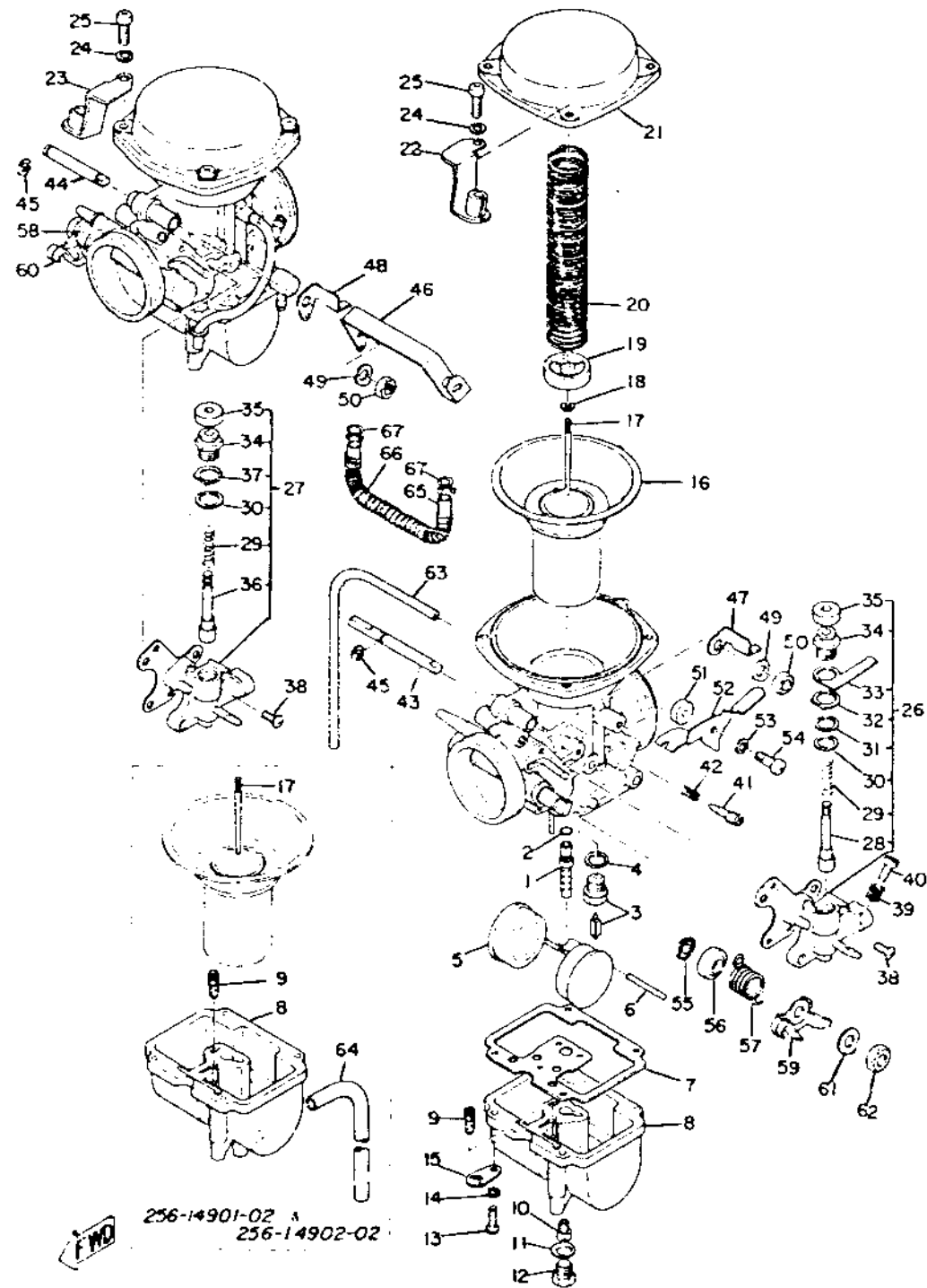

Ref. No.	Parts No.	Description	XS1/XS1B/XS2/T X650	Machine No.
57	256-14931-00-00	SPRING, throttle left	1	1
58	256-14932-00-00	SPRING, throttle right	1	1
59	256-14914-00-00	LEVER, throttle left	1	1
60	256-14915-00-00	LEVER, throttle right	1	1
61	256-14953-00-00	WASHER	2	2
62	95301-12600-00	NUT	2	2
63	183-14197-01-00	PIPE, overflow (3-160)	2	2
	256-14197-01-00	PIPE, overflow		2
64	256-14987-00-00	PIPE	2	2
65	90445-09079-00	PIPE, fuel (5-140) (170-24311-00)	1	1
66	90501-06028-00	SPRING (256-24333-00)	1	1
67	90467-08003-00	CLIP, pipe (101-24356-00)	2	2

15. CARBURETOR TYPE & MANUFACTURER	XS1		XS1B	
	BS38	Mikuni	BS38	Mikuni
MAIN JET (M.J.)	± 130		± 130	
AIR JET (A.J.)	-		1.2	
NEEDLE JET (N.J.)	Z-6		Z-6	
JET NEEDLE - clip position (J.N.)	4JN19-4		4JN19-4	
CUTAWAY (C.A.)	-		-	
PILOT JET (P.J.)	45		42.6	
AIR SCREW (Turns out) (A.S.)	1		One turn out	
STARTER JET (S.J.)	.6		.6	
FLOAT LEVEL (mm) (F.L.)	25mm		25mm	