

Ref. No	Part Number	Description	XS 1	XS 1B	XS 2	XS 650	Ref. Bull
1	256-17411-00-00	AXLE, main (14T)	1	1			
	306-17411-00-00	AXLE, main (12T)			1	1	
2	256-17141-01-00	GEAR, 4th pinion (21T)	1	1	1	1	
3	256-17154-00-10	WASHER, gear hold 5 (25.2-30-1.0)	}	U.R	U.R	U.R	U.R
	256-17154-00-12	WASHER, gear hold 5 (25.2-30-1.2)					
4	93440-25020-00	CIRCLIP	2	2	2	2	
5	256-17131-00-00	GEAR, 3rd pinion (20T)	1	1	1	1	
6	99999-00906-00	GEAR, 5th pinion (23T) (341-17151-00)	1	1	1	1	
	99999-00906-00	GEAR SET, 3rd & 5th	1	1	1	1	
	256-17131-03-00	GEAR, 3rd pinion	1	1	1	1	
	341-17151-03-00	GEAR, 5th pinion	1	1	1	1	
7	256-17121-00-00	GEAR, 2nd pinion (17T)	1	1	1	1	
8	137-17427-00-06	SH.M. drive axle (20.2-33-0.6)	}	U.R	U.R	U.R	U.R
	137-17427-00-09	SH.M. drive axle (20.2-33-1.0) (127-17427-00-10)					
9	93313-32006-00	BEARING	1				
	93313-32007-00	BEARING	1	1	1	1	00
10	93305-20504-00	BEARING (5205)	1	1	1	1	
11	93440-52014-00	CIRCLIP	1	1	1	1	
12	256-17421-00-00	AXLE, drive	1	1	1	1	
13	99999-00977-00	GEAR, 2nd wheel (27T) (256-17221-00)	1	1	1	1	
	99999-00977-00	GEAR SET, 3rd, 5th & 2nd wheel	1	1	1	1	
	256-17231-03-00	GEAR 3rd & 2nd wheel	1	1	1	1	
	256-17251-03-00	GEAR 5th wheel	1		1	1	
	256-17221-01-00	GEAR, 2nd wheel	1	1	1	1	
14	256-17241-01-00	GEAR, 4th wheel (23T)	1	1	1	1	
15	93440-30015-00	CIRCLIP	3	3	3	3	

	XS1/XS1B	XS:
17. PRIMARY REDUCTION RATIO & METHOD	72/27 2.666 gear	32/27
18. SECONDARY REDUCTION RATIO & METHOD	34/17 2.000 chain	34/17
19. TRANS. GEAR RATIOS 1st (Internal) (No. teeth) (Overall)	2.214 31/14 1.93	2.461
	2nd	1.588 27/17 8.45
	3rd	1.300 26/20 6.95
	4th	1.095 23 21 5.83
	5th	0.956 22 23 5.1
		0.956

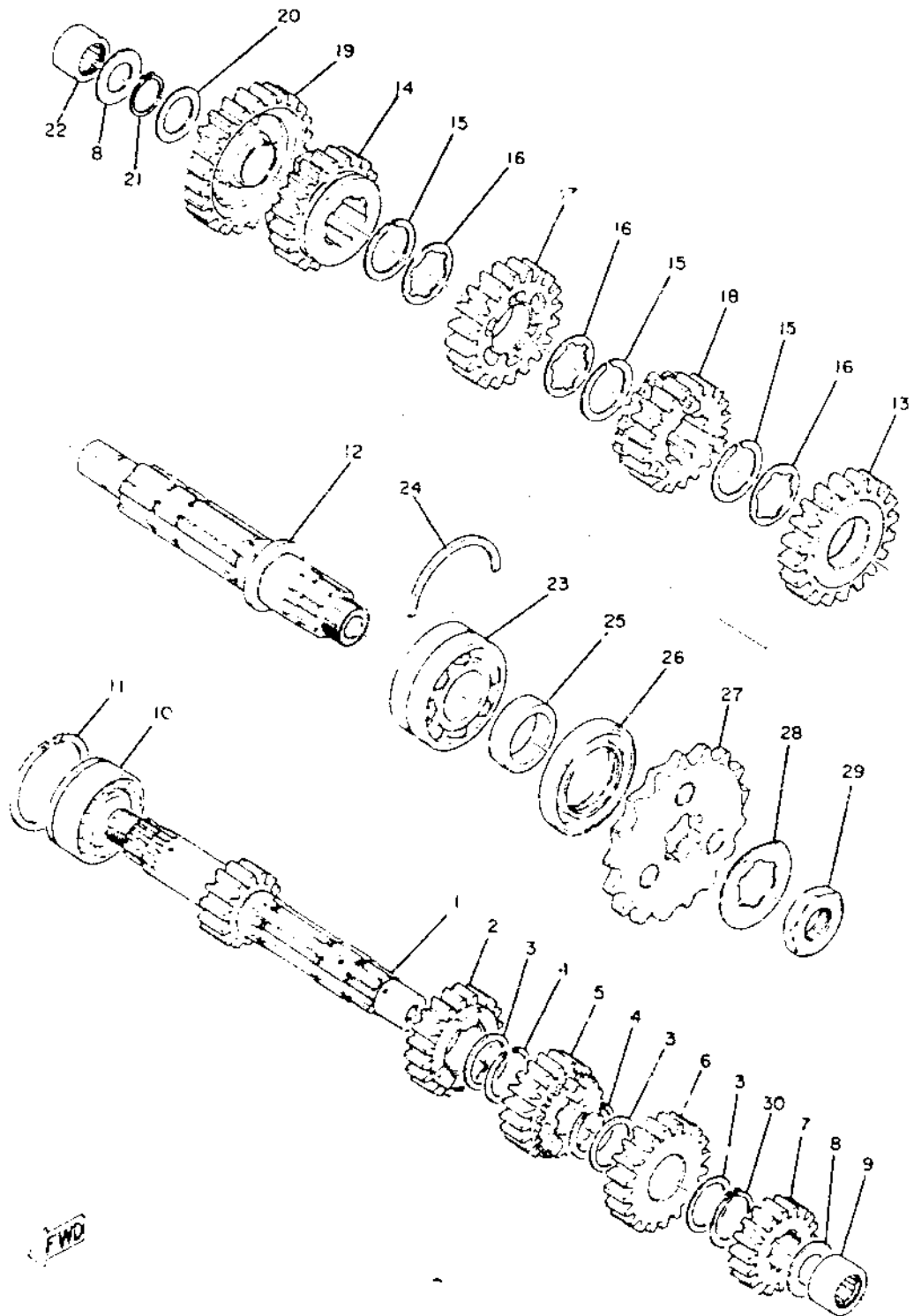

16	256-17236-00-10	WASHER, gear hold 3 (26.2-34-1.0)	U.R.	U.R.	U.R.	U.R.
	256-17236-00-12	WASHER, gear hold 3 (26.2-34-1.0)	3	3	3	3
17	256-17231-00-00	GEAR, 3rd wheel (26T)	1	1	1	1
	99999-00977-00	GEAR SET 3rd, 5th & 2nd (256-17231-00)	1	1	1	1
	256-17231-03-00	GEAR, 3rd wheel	1	1	1	1
	256-17251-03-00	GEAR, 5th wheel	1	1	1	1
	256-17221-01-00	GEAR, 2nd wheel	1	1	1	1
18	256-17251-00-00	GEAR, 5th wheel (22T)	1	1	1	1
	99999-00977-00	GEAR SET 3rd, 5th & 2nd (256-17251-00)	1	1	1	1
	256-17231-03-00	GEAR, 3rd wheel	1	1	1	1
	256-17251-03-00	GEAR, 5th wheel	1	1	1	1
	256-17221-01-00	GEAR, 2nd wheel	1	1	1	1
19	256-17211-00-00	GEAR, 1st wheel (31T)	1	1		
	306-17211-00-00	GEAR, 1st wheel (32T)			1	1
20	90201-20266-00	WASHER, gear hold (2G 25-1.0) (132-17216-00)	1	1	1	1
21	93410-20021-00	CIRCLIP (S-20)	1	1	1	1
22	93313-32005-00	BEARING	1	1	1	1
23	93305-20602-00	BEARING (5206) (93305-20601)	1	1	1	1
24	168-17424-00-00	CIRCLIP	1	1	1	1
25	90387-30200-00	COLLAR, distance (256-17462-00)	1	1	1	1
26	93105-40015-00	OIL SEAL (SDO-40-62-9)	1	1	1	1
27	256-17461-70-00	SPROCKET, drive (17T)	1	1	1	1
28	90215-26024-00	WASHER, lock (256-17464-00)	1	1	1	1
29	90179-22022-00	NUT, lock (256-17463-00)	1	1	1	1
30	93440-25020-00	CIRCLIP	1			
	93410-25017-00	CIRCLIP (S-25)	1	1	1	1

17. PRIMARY REDUCTION RATIO & METHOD	72/27 2.666 gear
18. SECONDARY REDUCTION RATIO & METHOD	34/17 2.000 chain
19. TRANS. GEAR RATIOS 1st (Internal) (No. Teeth) (Overall)	2.214 31/14 11.80
2nd	1.588 27/17 8.45
3rd	1.300 26/20 6.95
4th	1.095 23/21 5.83
5th	.956 22/23 5.10

18. PRIMARY REDUCTION RATIO & METHOD	
19. SECONDARY REDUCTION RATIO & METHOD	
20. TRANS. GEAR RATIOS 1st (INTERNAL) (NO. TEETH) (OVERALL)	

FWD