

# DOUBLE DISC BRAKE XS650C

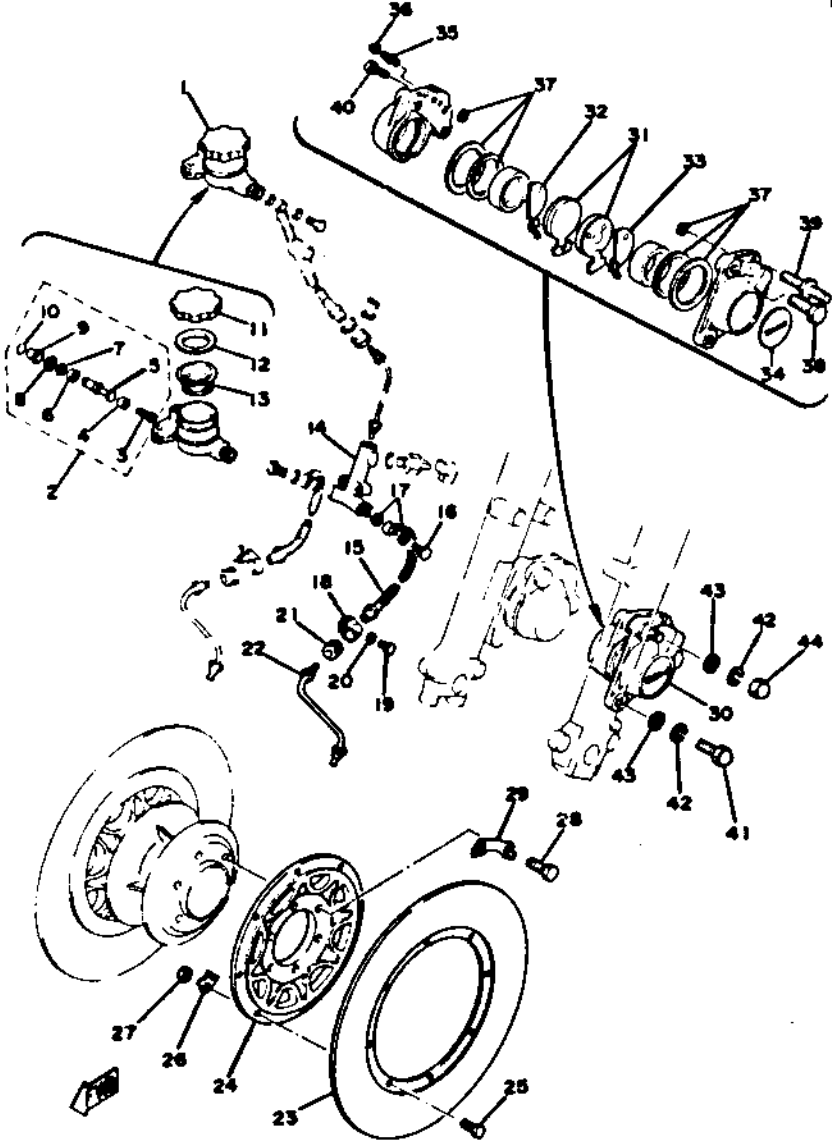

Ref. No.	Part Number	Description	A	B	C
1	341-25850-10-00	MASTER CYLINDER ASS'Y.....			1
2	341-20000-10-00	CYLINDER KIT, master (#3~10) ...			1
11	341-25852-30-00	CAP, reservoir .....			1
12	341-25855-30-00	BUSHING, diaphragm .....			1
13	341-25854-00-00	DIAPHRAGM, reservoir.....			1
14	[341-25885-10-00]	JOINT .....			1
15	341-25873-00-00	HOSE, brake 2 .....			1
16	90401-10034-00	BOLT, union .....			1
17	90201-10118-00	WASHER, plate .....			2
18	533-25875-00-00	HOLDER, brake hose left .....			1
19	97301-06025-00	BOLT .....			1
20	92903-06100-00	WASHER, spring .....			1
21	306-25881-00-00	RUBBER, brake 1.....			1
22	533-25871-00-00	PIPE, brake 1 .....			1
23	306-25831-00-00	DISC, brake.....			1
24	341-25832-01-00	BRACKET, disc.....			1
25	90109-06018-00	BOLT (306-25833-00)			8
26	90215-06106-00	WASHER, lock (306-25834-00) .....			8
27	95301-06600-00	NUT.....			8
28	90109-08367-00	BOLT .....			6
29	341-25412-00-00	WASHER, lock.....			3
30	533-25810-01-00	CALIPER ASS'Y.....			1

## XS650C

# DOUBLE DISC BRAKE XS650C

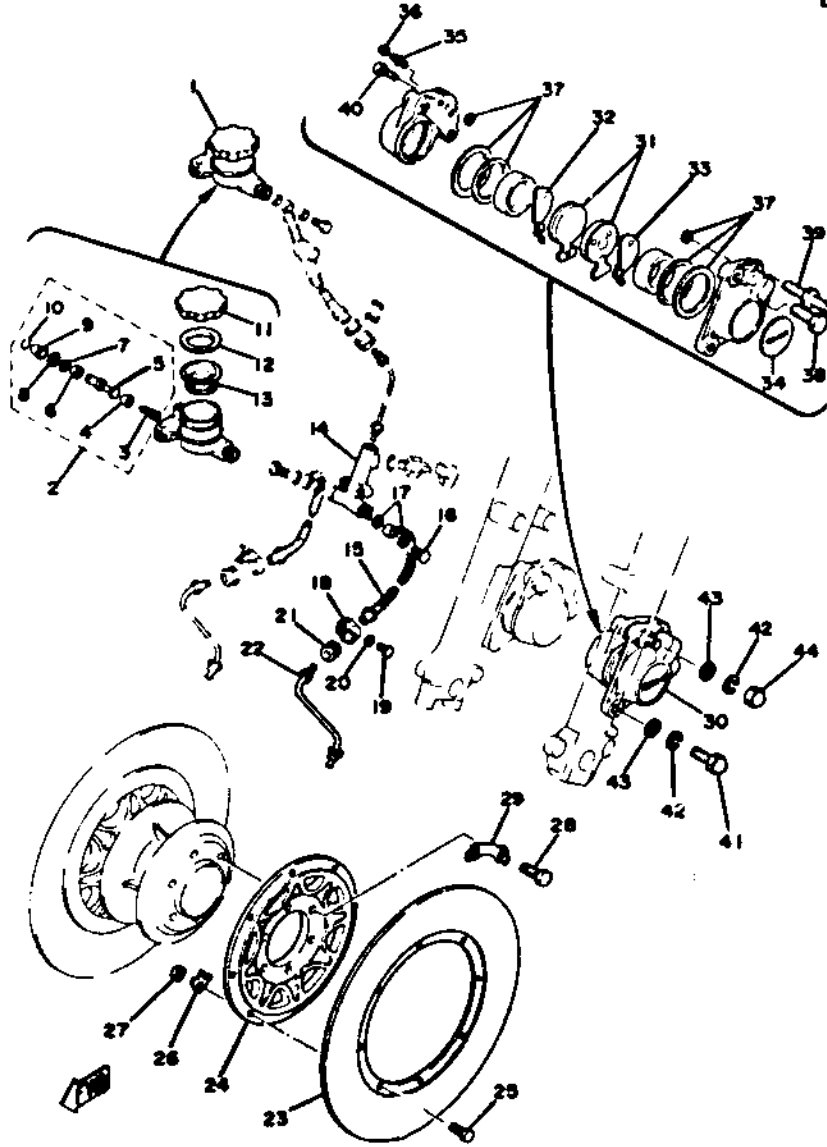

Ref. No.	Part Number	Description	A	B	C
31	1A1-W0045-00-00	PAD, caliper.....			2
32	409-25827-50-00	SHIM 1.....			1
33	409-25828-50-00	SHIM 2.....			1
34	306-25829-00-00	EMBLEM, caliper			1
35	306-25824-00-00	SCREW, bleed....			1
36	306-25825-01-00	CAP.....			1
37	856-W0047-00-00	CALIPER SEAL KIT			1

## XS650C

39	306-25833-01-00	BOLT, bridge 2.....			1
40	306-25826-01-00	BOLT, bridge 3.....			2
41	90109-10041-00	BOLT (306-25818-00)			1
42	92903-10100-00	WASHER, spring ....			2
43	92903-10200-00	WASHER, plain .....			2
44	90176-10013-00	NUT, cap.....			1

## XS650C