

# FRONT FORK

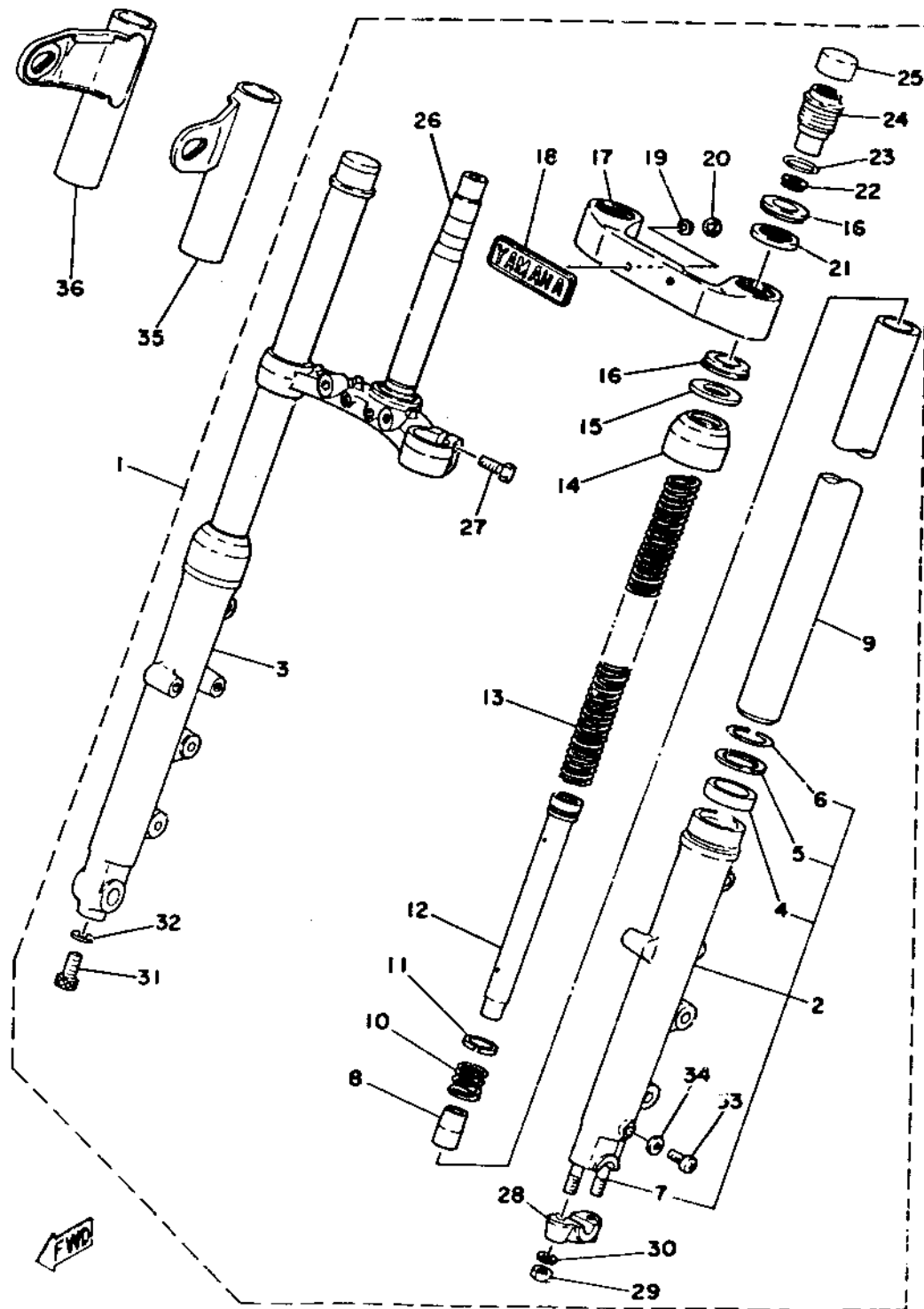

Ref. No.	Part No.	Description	Qty.	Applic. Machine No.
1	2M0-23101-00-00	FRONT FORK ASS'Y	1	
2	2F0-23126-00-00	FORK TUBE, outer left	1	
3	2F0-23136-00-00	FORK TUBE, outer right	1	
4	1T3-23145-00-00	OIL SEAL	2	
5	341-23146-50-00	WASHER, oil seal	2	
6	341-23156-50-00	CLIP, oil seal	2	
7	90116-08261-00	BOLT, stud	2	
8	1W1-23173-L0-00	PIECE, oil lock	2	
9	2F0-23110-00-00	INNER TUBE COMP.	2	
10	2F0-23151-00-00	SPRING, rebound	2	
11	2F0-23157-00-00	RING, front fork piston	2	
12	2F0-23110-00-00	CYLINDER COMP., front fork	2	
13	2F0-23141-00-00	SPRING, front fork	2	
14	1T3-23144-50-00	SEAL, dust	2	
15	1T3-23146-50-00	WASHER	2	
16	1T3-23163-51-00	GASKET	4	
17	2M0-23122-00-00	COVER, fork	1	
18	2M0-23395-00-00	EMBLEM, front	1	
19	90202-04003-00	WASHER (174-28316-00)	2	
20	90183-04005-00	NUT, spring (116-28317-01)	2	
21	1T3-23116-51-00	GUIDE, cover	2	
22	2F0-23149-00-00	WASHER	2	
23	2F0-23114-00-00	RING, cap bolt	2	
24	2F0-23111-00-00	BOLT, cap	2	
25	2F0-23168-00-00	CAP, front fork	2	
26	1T3-23340-50-33	UNDERBRACKET COMP.	1	
27	2M0-23340-00-33	UNDERBRACKET COMP. (1T3-23340-50-33)	1	

SUSPENSION		
Front Forks:	Oil type/level/qty	10 wt. Fork Oil / $\phi$ / 164 - 172cc
	Spring Length std	482mm

FRONT FORK

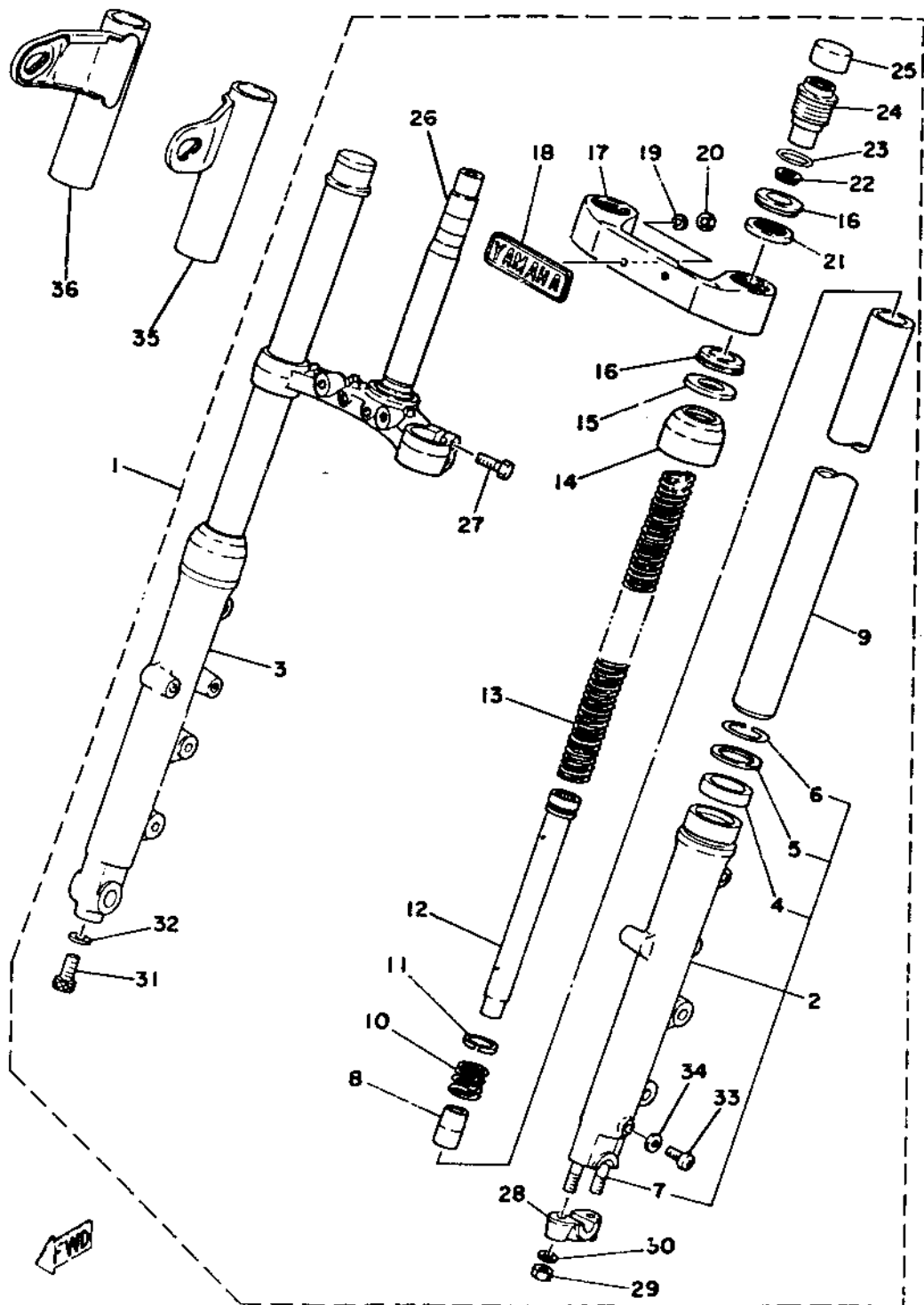

Ref. No.	Part No.	Description	Qty.	Applicable Machine No.
27	90119-08C12-00	BOLT	4	
28	341-23167-50-00	HOLDER, axle	1	
29	90185-08054-00	NUT	2	
30	90201-08544-00	WASHER, plate	2	
31	278-23181-50-00	BOLT, hexagon socket head	2	
32	509-23158-L0-00	GASKET	2	
33	98501-04008-00	PLUG, drain (122-23119-01)	2	
34	122-23129-00-00	GASKET, drain plug	2	
35	2M0-23121-00-93	COVER, upper left	1	
36	2M0-23131-00-93	COVER, upper right	1	

SUSPENSION		
Front Forks:	Oil type/level/qty	10 wt. Fork Oil / $\phi$ / 164 - 172cc
	Spring Length std.	482mm