

Ref. No.	Part Number	Description	Qty.	Applicable Machine No.
1	2M0-25850-00-00	MASTER CYLINDER ASS'Y	1	
2	635-W0041-60-00	CYLINDER KIT, master (535-20000-60)	1	
3	1J3-25852-01-00	CAP, reservoir	1	
4	98706-05030-00	SCREW, cap (98703-05030)	4	
5	1J3-25855-01-00	BUSHING, diaphragm	1	
6	1J3-25854-01-00	DIAPHRAGM, reservoir	1	
7	1J3-25867-00-00	BRACKET, master cylinder	1	
8	97313-06025-00	BOLT, hexagon (97323-06025)	2	
9	92903-06100-00	WASHER, spring	2	
10	2H7-83922-00-00	LEVER, right	1	
11	90149-06131-00	SCREW, oval head (90146-06008)	1	
12	90170-06010-00	NUT (306-83927-00)	1	
13	90501-10312-00	SPRING (306-83924-00)	1	
14	90109-06465-00	SCREW	1	
15	90386-08094-00	BUSHING	1	
16	95601-06100-00	NUT, U	1	
17	90338-09012-00	PLUG, blind (341-26329-00)	1	
18	90401-10034-00	BOLT, union	4	
19	90201-10118-00	WASHER, plate (306-25878-00)	8	
20	306-25862-00-00	BOLT, master cylinder	1	
21	2M0-25872-00-00	HOSE, brake 1	1	
22	1J7-25885-01-00	JOINT	1	
23	97301-06025-00	BOLT, hexagon	1	
24	92903-06100-00	WASHER, spring	1	
25	92901-06600-00	WASHER, plate	1	
26	1T3-25873-00-00	HOSE, brake 2	1	
27	1J3-25875-02-00	HOLDER, brake hose right	1	
28	1A0-83980-30-00	FRONT STOP SWITCH ASS'Y	1	
29	1T5-26372-00-00	COVER, handle lever right	1	

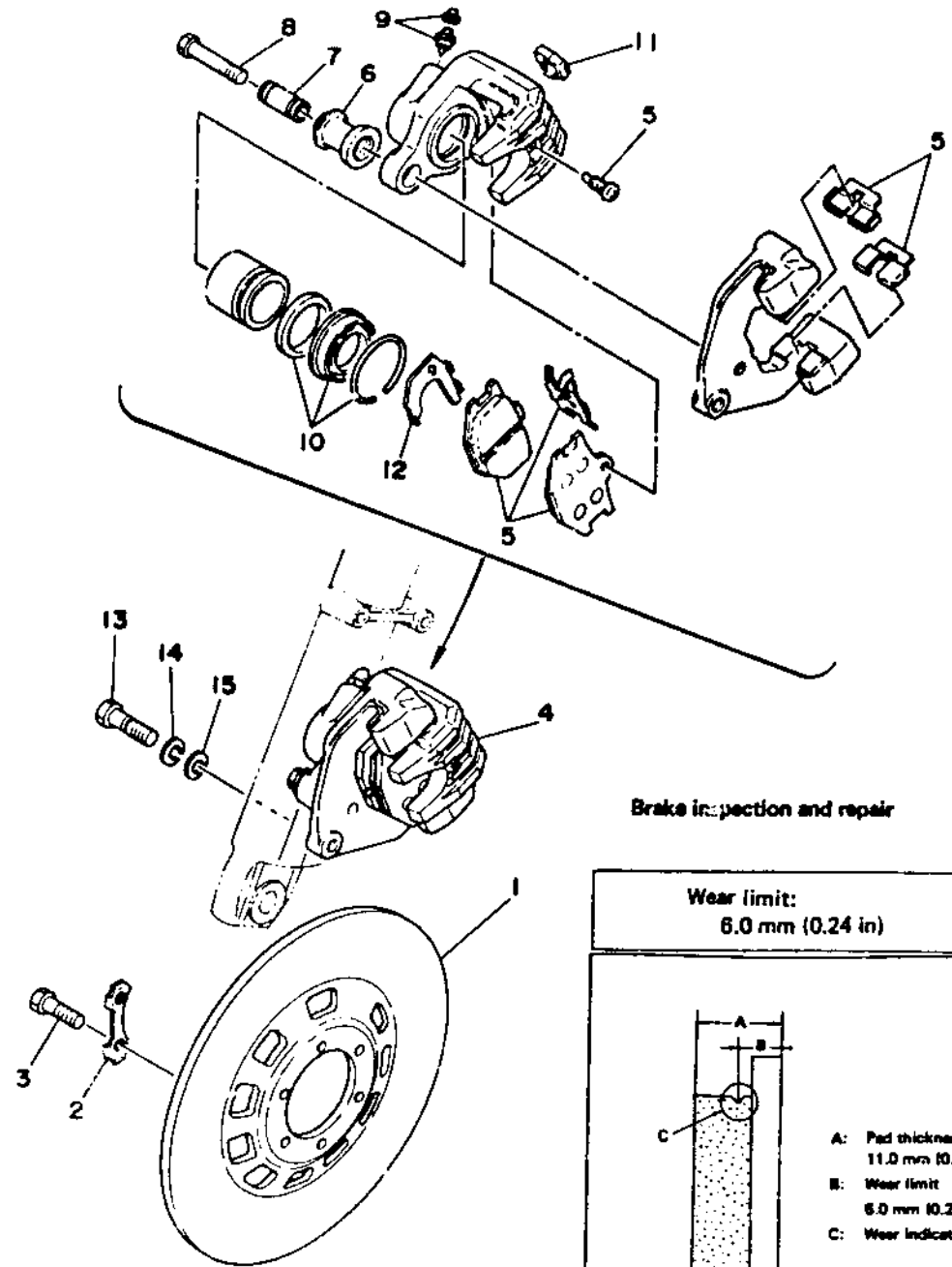

Brake inspection and repair

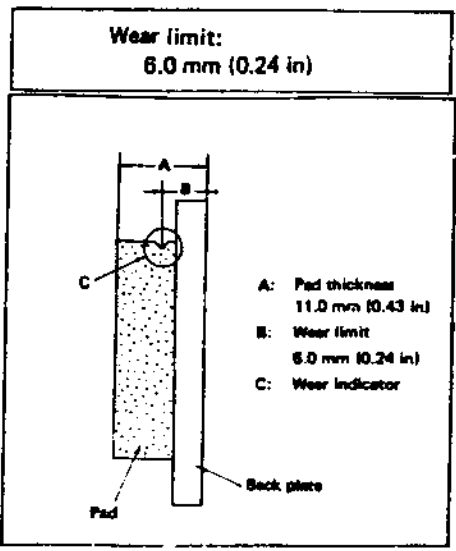

Ref. No.	Part Number	Description	Qty.	App. ca. Mechan. No.
1	1J3-25831-00-00	DISC, front brake	1	
2	1J3-25834-01-00	WASHER, lock	3	
3	90101-08312-00	BOLT, hexagon (90101-08307)	6	
4	1J3-25810-04-00	FRONT CALIPER ASS'Y, right (1J3-25810-03)	1	
5	1J3-20000-13-00	. CALIPER PAD KIT	1	
6	1J3-25917-00-00	. BUSHING, boot	1	
7	1J3-25838-00-00	. SLEEVE	1	
8	90105-08092-00	. BOLT, support	1	
9	1J3-W0048-00-00	. SCREW, bleed with cap (1J3-20000-30)	1	
10	1J3-20000-20-00	. CALIPER SEAL KIT	1	
	1J3-W0047-00-00	. CALIPER SEAL KIT (1J3-20000-20)	1	
11	1J3-25845-01-00	. CAP, indicator	1	
12	1J3-25827-00-00	. SHIM	1	
13	90101-10308-00	BOLT, hexagon	2	
14	92903-10100-00	WASHER, spring	2	
15	92903-10200-00	WASHER, plain	2	

