

Ref. No.	Part No.	Description	Qty.	Applicable Machine No.
1	447-12170-00-00	CAMSHAFT ASS'Y	1	
2	90386-12093-00	BUSHING (256-11154-00)	2	
3	256-11155-00-00	SEAL, labyrinth	2	
4	93316-00503-00	BEARING (B16005 special)	4	
5	93101-25044-00	OIL SEAL (S-25-40-6)	2	
6	256-11156-00-00	SHAFT, breaker	1	
7	93603-07073-00	PIN, dowel (3-7)	3	
8	95301-06600-00	NUT, hexagon	2	
9	92903-06100-00	WASHER, spring	2	
10	447-12220-00-00	TENSIONER ARM ASS'Y	1	
11	90149-06009-00	BOLT, reamer (256-12248-00)	2	
12	92503-06015-00	SCREW, pan head	2	
13	92903-06100-00	WASHER, spring	4	
14	306-12213-01-00	GASKET, tensioner case 1	1	
15	584-12211-00-00	HOLDER, tensioner	1	
16	97303-06018-00	BOLT, hexagon	6	
17	92903-06200-00	WASHER, plain	6	
18	341-12217-03-00	ROD	1	
19	90501-14095-00	SPRING (341-12216-02)	1	
20	341-12232-01-00	DAMPER	1	
21	90109-18307-00	BOLT (341-12228-00)	1	
22	93210-22366-00	O-RING (2.6-20.6)	1	
23	90176-18021-00	NUT, cap	1	
24	256-12231-01-00	GUIDE, stopper 1	1	
25	90430-06014-00	GASKET (256-11396-00)	2	
26	97303-06020-00	BOLT, hexagon	2	

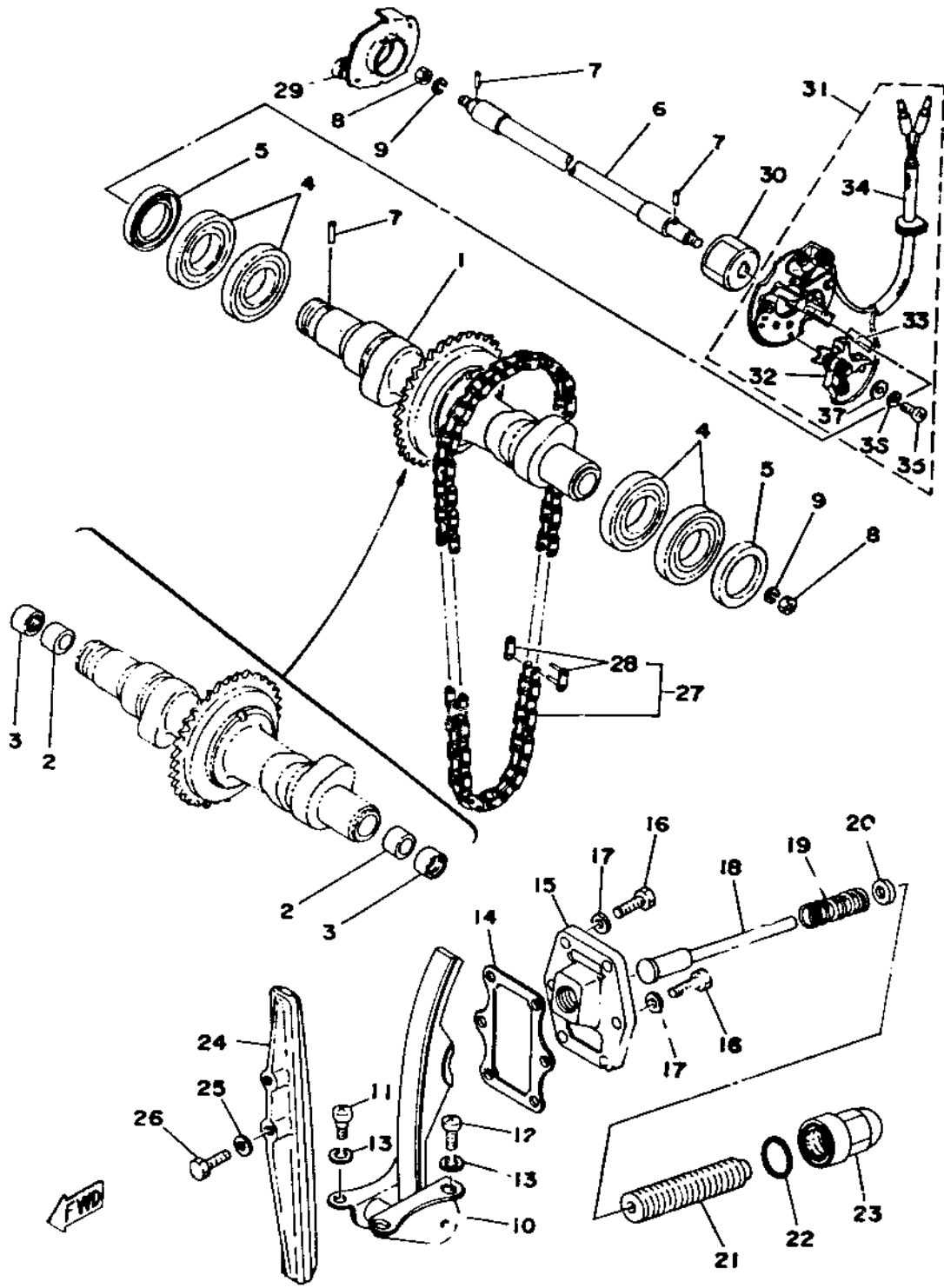

Ref. No.	Part Number	Description	Qty.	App. Mkt. Nr.
27	94562-19106-00	CHAIN (DK2 19FT 106L).....	1	U.R.
	94500-02106-00	CHAIN (DK002 106L).....		
28	94662-19001-00	. JOINT. chain	1	U.R.
	94800-02001-00	. JOINT. chain		
29	256-81653-10-00	GOVERNOR ASSY.....	1	
30	256-81651-10-00	CAM.....	1	
31	447-81620-10-00	BREAKER PLATE ASSY.....	1	
32	256-81621-11-00	. CONTACT BREAKER	2	
33	256-81631-10-00	. LUBRICATOR	2	
34	256-81815-10-00	. WIRE lead	1	
35	110-81345-21-00	. SCREW, pan head (M4-8) (110-81345-20)	6	
36	92901-04100-00	. WASHER, spring	6	
37	92901-04200-00	. WASHER, plain	6	