

No.	Number	Description	Qty.
1	447-12170-00-00	CAMSHAFT ASS'Y.....	1
2	90386-12093-00	. BUSHING (256-11154-00)....	2
3	256-11155-00-00	. SEAL, labyrinth.....	2
4	93316-00503-00	BEARING (B16005 special)....	4
5	93101-25044-00	OIL SEAL (S-25-40-6).....	2
6	256-11156-00-00	SHAFT, breaker.....	1
7	93603-07073-00	PIN, dowel (3-7).....	3
8	95301-06600-00	NUT, hexagon.....	2
9	92903-06100-00	WASHER, spring (92901-06100)	2
10	447-12220-00-00	TENSIONER ARM ASS'Y.....	1

#### TUNE-UP KIT

	ACC-01100-37-01	TUNE-UP KIT.....	1
	256-81621-11-00	. CONTACT BREAKER.....	2
	256-81625-10-00	. CONDENSER.....	1
	(1J7-28121-00-00)	. POINT GAUGE.....	1
*	NGK-BP7ES-00-00	. SPARK PLUG (94701-00117)	2
11	90149-06009-00	BOLT, reamer (256-12248-00) ...	2
12	92503-06015-00	SCREW, pan head (92501-06015)	2
13	92903-06100-00	WASHER, spring (92901-06100)	4
14	306-12213-02-00	GASKET, tensioner case 1.....	1
15	584-12211-00-00	HOLDER, tensioner.....	1
16	97303-06018-00	BOLT, hexagon.....	6
17	92903-06200-00	WASHER, plain (92901-06200)	6
18	341-12217-04-00	ROD.....	1
19	90501-14095-00	SPRING (341-12216-02).....	1
20	341-12232-01-00	DAMPER.....	1

\*Indicates new part numbers activated from March, 1982.

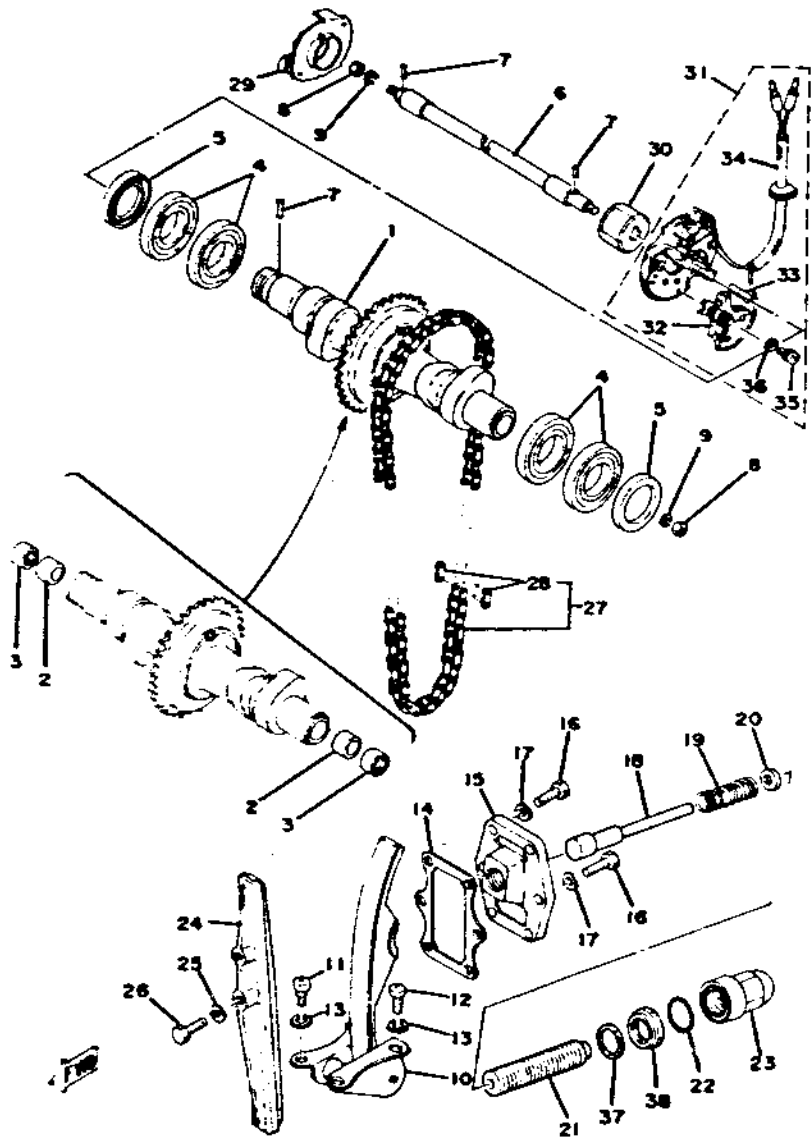

No.	Number	Description	Qty.
	99999-01144-00	BOLT (90109-18307) .....	1
	90109-18580-00	. BOLT .....	1
	2H0-12232-00-00	. DAMPER, chain tensioner ....	1
22	93210-21190-00	O-RING (2.6-20.6).....	1
23	90176-18021-00	NUT, cap .....	1
24	256-12231-01-00	GUIDE, stopper 1 .....	1
25	90430-06014-00	GASKET (256-11396-00).....	2
26	97303-06020-00	BOLT, hexagon .....	2
27	94562-19106-00	CHAIN (DK219FT-106L) .....	1
	94500-02106-00	CHAIN (DK002-106L).....	1
28	94662-19001-00	. JOINT, chain.....	1
	94600-02001-00	. JOINT, chain.....	1
<b>TUNE-UP KIT</b>			
	ACC-01100-37-01	TUNE-UP KIT .....	
	256-81621-11-00	. CONTACT BREAKER.....	2
	256-81625-10-00	. CONDENSER .....	1
	(1J7-28121-00-00)	. POINT GAUGE.....	1
*	NGK-BP7ES-00-00	. SPARK PLUG (94701-00117)	2
29	256-81653-10-00	GOVERNOR ASS'Y.....	1
30	256-81651-10-00	CAM .....	1
31	447-81620-10-00	BREAKER PLATE ASS'Y .....	1
32	256-81621-11-00	. CONTACT BREAKER.....	2
33	256-81631-10-00	. LUBRICATOR.....	2
34	256-81615-10-00	. WIRE, lead .....	1
35	110-81345-21-00	. SCREW, pan head (M4-6) ....	6
36	92901-04200-00	. WASHER, plain .....	6
37	90430-18130-00	GASKET .....	1
38	90179-18274-00	NUT.....	1

\*Indicates new part numbers activated from March, 1982.