

Ref. No.	Part Number	Description	Qty.
* 1	306-17411-03-00	AXLE, main (13T)(306-17411-02)	1
2	256-17141-02-00	GEAR, 4th pinion (21T).....	1
3	90201-25287-00	WASHER, plate.....	1
4	93440-25020-00	CIRCLIP.....	1
5	256-17131-04-00	GEAR, 3rd pinion (20T).....	1
6	341-17151-04-00	GEAR, 5th pinion (23T).....	1
7	90201-25287-00	WASHER, plate.....	2
8	93440-25020-00	CIRCLIP.....	1
9	93410-25017-00	CIRCLIP.....	1
10	256-17121-01-00	GEAR, 2nd pinion (17T).....	1
11	137-17427-00-09	SHIM (0.9T).....	1
12	93313-32007-00	BEARING, cylindrical.....	1
13	93305-20504-00	BEARING (B5205).....	1
14	93440-52014-00	CIRCLIP.....	1
15	256-17421-02-00	AXLE, drive.....	1
16	256-17221-02-00	GEAR, 2nd wheel (27T).....	1
17	256-17236-00-10	WASHER, gear hold 3.....	1
	256-17236-00-12	WASHER, gear hold 3.....	1
18	93440-30015-00	CIRCLIP.....	1
19	256-17251-04-00	GEAR, 5th wheel (22T).....	1
20	256-17231-04-00	GEAR, 3rd wheel (26T).....	1

*Indicates new part numbers activated from March, 1981.

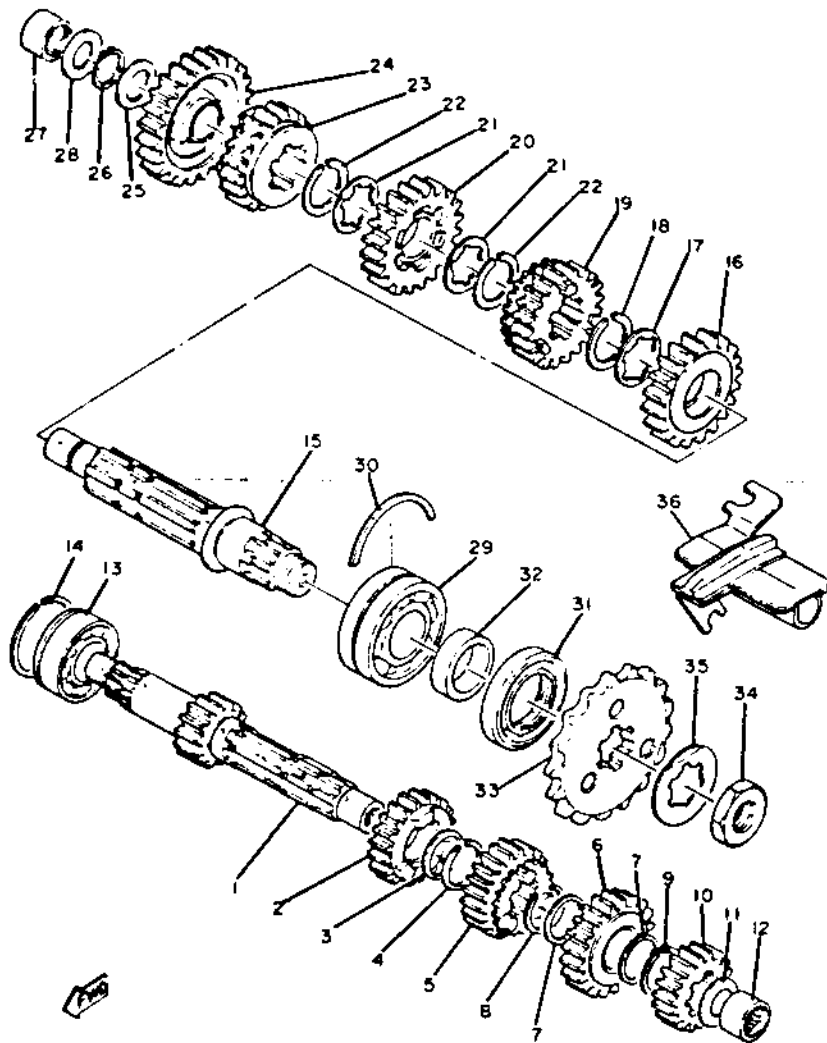

No.	Number	Description	Qty.
21	256-17236-00-10	WASHER, gear hold 3.....	2
	256-17236-00-12	WASHER, gear hold 3.....	2
22	93440-30015-00	CIRCLIP	2
23	256-17241-02-00	GEAR, 4th wheel (23T).....	1
24	306-17211-00-00	GEAR, 1st wheel (32T).....	1
25	90201-20266-00	WASHER, plate.....	1
26	93410-20021-00	CIRCLIP	1
27	93313-32005-00	BEARING, cylindrical	1
28	137-17427-00-09	SHIM (0.9T).....	1
29	93305-20602-00	BEARING (B5206 special)	1
30	168-17424-00-00	CIRCLIP 1	1
31	93105-40018-00	OIL SEAL	1
32	90387-30200-00	COLLAR	1
33	256-17461-71-00	SPROCKET, drive (17T).....	1
34	90179-22022-00	NUT.....	1
35	90215-26024-00	WASHER, lock.....	1
36	447-17467-02-00	GUIDE, chain.....	1

TRANSMISSION - Oil Type/Qty Chg/Qty Reassemble	See ENGINE Lubricant
Primary Drive Type/Teeth/Ratio	Spur Gear / 72-27 / 2.666
Secondary Drive Type/Teeth/Chain	Chain / 34-17 / DID530HDS-104L