

Ref. No.	Part Number	Description	Qty.
1	4R1-23101-00-00	FRONT FORK ASS'Y.	1
2	3H5-23;26-00-00	TUBE, outer 1	1
3	3H5-23136-00-00	TUBE, outer 2	1
4	3H5-23156-00-00	CLIP, oil seal	2
5	2H7-23145-00-00	OIL SEAL	2
6	90116-08261-00	BOLT, stud	2
7	3H5-23110-00-00	INNER TUBE COMP. 1	2
8	3H5-23170-00-00	CYLINDER COMP., front fork	2
9	1W1-23173-L0-00	SPINDLE, taper	2
10	3H5-23144-00-00	SEAL, dust	2
11	240-23114-00-00	GASKET	2
12	509-23163-L0-00	O-RING	2
13	2H7-23340-00-33	UNDERBRACKET COMP.	1
14	3H5-23141-00-00	SPRING, front fork	2
15	583-23142-00-00	SEAT, spring upper	2
16	2H7-23132-00-00	COVER, outer 2	1
17	2H7-23122-00-00	COVER, outer 1	1
18	2H7-23115-00-00	GUIDE, cover upper	2
19	2H7-23116-00-00	GUIDE, cover lower	2
20	2H7-23163-00-00	WASHER	2

SUSPENSION	
Front Forks, Oil Type / Level / Qty	10 Wt. Fork Oil* / @ / 25cc ± 4cc
Gas Pressure	0.4 kg/cm ² (5.7 psi)
Spring Length Std	516mm

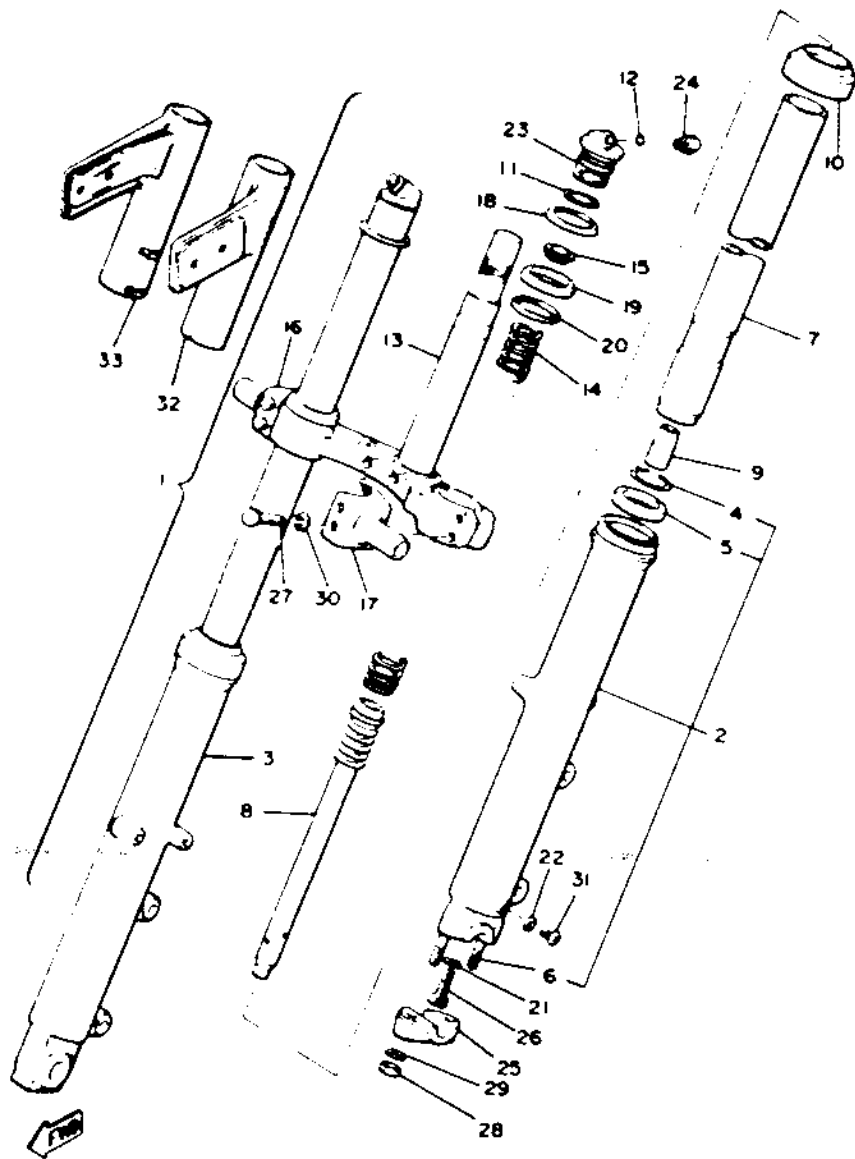

Ref. No.	Part Number	Description	Qty.
21	509-23158-L0-00	GASKET	2
22	122-23129-00-00	GASKET, drain plug	2
23	4R1-23111-00-00	BOLT, cap	2
24	3H5-23190-00-00	AIR VALVE COMP.	2
25	341-23167-50-00	HOLDER, axle	1
26	278-23181-50-00	BOLT, hexagon socket head	2
27	90101-08262-00	BOLT	4
28	90185-08054-00	NUT, self-locking	2
29	90201-08544-00	WASHER, plate	2
30	92903-08100-00	WASHER, spring (92901-08100)	4
31	122-23119-01-00	PLUG, drain	2
32	2H7-23121-00-93	COVER, upper 1	1
33	2H7-23131-00-93	COVER, upper 2	1

SUSPENSION	
Front Forks Oil Type / Level / Qty	10 Wt Fork Oil @ 236cc ± 4cc
Gas Pressure	0.4 kg. cm ² (5.7 psi)
Spring Length Std	516mm