

Ref. No.	Part Number	Description	Qty.	Remarks
1	2H7-11411-02-00	CRANKSHAFT.....	1	
2	93101-32087-00	OIL SEAL	1	
3	93101-32088-00	OIL SEAL	1	
4	2H7-11416-01-00	PLANE BEARING, crankshaft 1	9	U.R. Blue
	2H7-11416-11-00	PLANE BEARING, crankshaft 1	9	U.R. Black
	2H7-11416-21-00	PLANE BEARING, crankshaft 1	9	U.R. Brown
	2H7-11416-31-00	PLANE BEARING, crankshaft 1	9	U.R. Green
	2H7-11416-41-00	PLANE BEARING, crankshaft 1	9	U.R. Yellow
5	2H7-11633-01-00	PIN, piston.....	4	
6	2H7-11417-01-00	PLANE BEARING, crankshaft 2	1	U.R. Blue
	2H7-11417-11-00	PLANE BEARING, crankshaft 2	1	UR. Black
	2H7-11417-21-00	PLANE BEARING, crankshaft 2	1	U.R. Brown
	2H7-11417-31-00	PLANE BEARING, crankshaft 2	1	U.R. Green
	2H7-11417-41-00	PLANE BEARING, crankshaft 2	1	U.R. Yellow
7	90468-12069-00	CLIP	8	
8	3H5-11631-00-46	PISTON (STD)	4	
	3H5-11635-00-00	PISTON (1st O/S 0.25mm).....	4	Alternate Parts
	3H5-11636-00-00	PISTON (2nd O/S 0.50mm).....	4	Alternate Part
	3H5-11637-00-00	PISTON (3rd O/S 0.75mm).....	4	Alternate Part
	3H5-11638-00-00	PISTON (4th O/S 1.00mm).....	4	Alternate Part
9	3J2-11610-00-00	PISTON RING SET (STD).....	4	STD
	3J2-11610-10-00	PISTON RING SET (1st O/S)....	4	Alternate Part
	3J2-11610-20-00	PISTON RING SET (2nd O/S) ...	4	Alternate Part
	3J2-11610-30-00	PISTON RING SET (3rd O/S)....	4	Alternate Part
	3J2-11610-40-00	PISTON RING SET (4th O/S)....	4	Alternate Part
10	1J7-11650-01-00	CONNECTING ROD ASS'Y	4	
11	1J7-11654-00-00	. BOLT, connecting rod	2	

Piston Skirt Clearance New / Max	0.060 ~ 0.065mm / 0.1mm
Ring End Gap Top / 2nd / 3rd	0.2 ~ 0.4mm / 0.2 ~ 0.4mm / 0.2 ~ 0.9mm

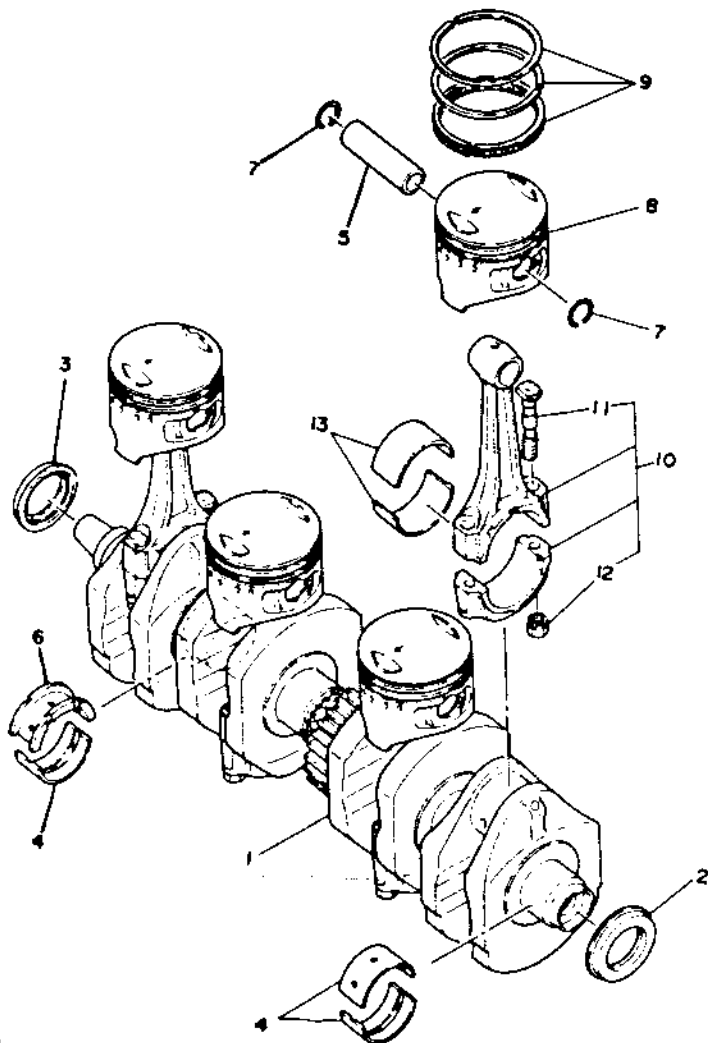

Ref. No.	Part Number	Description	Qty.	Remarks
12	90170-09192-00	NUT	2	
13	2F3-11656-00-00	PLANE BEARING, connecting rod	8	U.R. Blue
	2F3-11656-10-00	PLANE BEARING, connecting rod	8	U.R. Black
	2F3-11656-20-00	PLANE BEARING, connecting rod	8	U.R. Brown
	2F3-11656-30-00	PLANE BEARING, connecting rod	8	U.R. Green
	2F3-11656-40-00	PLANE BEARING, connecting rod	8	UR. Yellow

CONNECTING ROD BEARING SELECTION

Housing No. - Shaft No. = Bearing No.

	Center Thickness T	Housing Diameter	No.	Shaft Diameter	No.	Oil Clearance
		45.5φ +0.024 +0.016	4	42.5φ 0 -0.008	1	0.042~0.064
BEARING 1 (Blue)	1.5 +0.001 -0.003	45.5φ +0.016 +0.008	5	42.5φ -0.009 -0.016	2	0.042~0.064
BEARING 2 (Black)	1.5 -0.003 -0.007	45.5φ +0.008 0	6	42.5φ -0.017 -0.024	3	0.042~0.064
BEARING 3 (Brown)	1.5 -0.007 -0.011					0.042~0.064
BEARING 4 (Green)	1.5 -0.011 -0.015					0.042~0.064
BEARING 5 (Yellow)	1.5 -0.015 -0.019					0.042~0.064

CRANKSHAFT BEARING SELECTION

Housing No. - Shaft No. = Bearing No.

	Center Thickness T	Housing Diameter	No.	Shaft Diameter	No.	Oil Clearance
		39φ +0.024 0.016	4	36φ 0 -0.008	1	0.035~0.059
BEARING 1 (Blue)	1.5 +0.006 +0.002	39φ +0.016 +0.008	5	36φ -0.009 -0.016	2	0.035~0.059
BEARING 2 (Black)	1.5 +0.002 -0.002	39φ +0.008 0	6	36φ -0.017 -0.024	3	0.035~0.059
BEARING 3 (Brown)	1.5 -0.002 -0.006					0.035~0.059
BEARING 4 (Green)	1.5 -0.006 -0.010					0.035~0.059
BEARING 5 (Yellow)	1.5 -0.010 -0.014					0.035~0.059

Piston Skirt Clearance New / Max	0.060 ~ 0.065mm / 0.1mm
Ring End Gap Top / 2nd / 3rd	0.2 ~ 0.4mm / 0.2 ~ 0.4mm / 0.2 ~ 0.3mm