

Ref. No.	Part Number	Description	Qty.
1	2H7-13336-00-00	HOUSING, rotor	1
2	2H7-13330-00-00	PUMP SHAFT ASS'Y	1
3	2H7-13316-00-00	COVER, pump	1
4	90149-06126-00	SCREW	3
5	2H7-13325-00-00	GEAR, pump driven (52T)	1
6	93603-12007-00	PIN, dowel	1
7	92903-06100-00	WASHER, spring (92901-06100)	1
8	95303-06600-00	NUT	1
9	2H7-13483-00-00	PLUNGER, relief	1
10	90501-18499-00	SPRING, compression	1
11	2F3-13411-00-00	STRAINER, oil (1J7-13411-01)	1
12	98503-05012-00	SCREW, pan head (98301-05012)	3
13	2H7-13327-00-00	COVER, pump gear	1
14	91316-06035-00	BOLT (91318-06035)	1
15	2H7-13412-00-00	HOUSING, strainer	1
16	91316-06025-00	BOLT (91316-06025)	2
17	93210-18319-00	O-RING	1
18	91810-03014-00	PIN, dowel	2
19	91311-06025-00	BOLT	1
20	91311-06035-00	BOLT	2

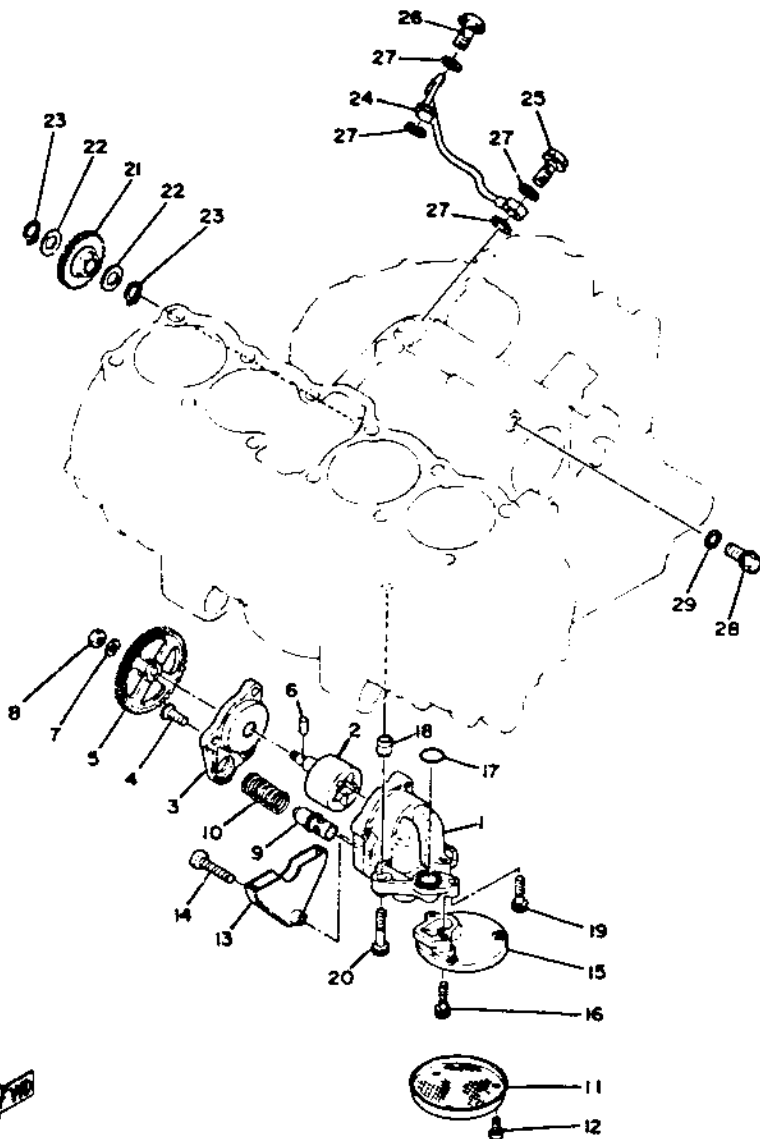

Ref. No.	Part Number	Description	Qty.
21	2H7-13341-00-00	GEAR, oil pump idle (37T) . . . . .	1
22	90201-12471-00	WASHER, plate . . . . .	2
23	93410-12003-00	CIRCLIP . . . . .	2
24	2H7-13161-00-00	PIPE, delivery 1 . . . . .	1
25	90401-10013-00	BOLT, union . . . . .	1
26	90401-10004-00	BOLT, union . . . . .	1
27	90430-10027-00	GASKET . . . . .	4
28	90401-10051-00	BOLT, union . . . . .	1
29	90430-10027-00	GASKET . . . . .	1