

Ref. No.	Part Number	Description	Qty.
1	2H7-17401-00-00	MAIN AXLE COMP. (17T)	1
2	2H7-17141-01-00	GEAR, 4th pinion (31T)	1
3	90201-28665-00	WASHER, plate	1
4	93440-28062-00	CIRCLIP	1
5	2H7-17121-00-00	GEAR, 2nd/3rd pinion (24/38T)	1
6	90201-25287-00	WASHER, plate	1
7	93410-25017-00	CIRCLIP	1
8	2H7-17151-00-00	GEAR, 5th pinion (34T)	1
9	2H7-17417-00-00	SHIM 1	1
10	93305-20506-00	BEARING (B5205)	1
11	93440-52014-00	CIRCLIP	1
12	93311-52031-00	BEARING, cylindrical	1
13	93440-32063-00	CIRCLIP	1
14	2H7-17421-01-00	AXLE, drive	1
15	2H7-17211-00-00	GEAR, 1st wheel (38T)	1
16	2H7-17258-00-00	COLLAR 1	1
17	90201-30666-00	WASHER, plate	1
18	93410-30012-00	CIRCLIP	1
19	2H7-17241-00-00	GEAR, 4th wheel (32T)	1
20	2H7-17231-01-00	GEAR, 3rd wheel (36T)	1

TRANSMISSION - Oil Type/Qty Chg/Qty Reassembld	See ENGINE Above
Primary Drive Type / Teeth / Ratio	Spur Gear / 25-25 x 58-36 / 1.867
Secondary Drive Type / Teeth / Chain	Shaft / 44-47 x 19-18 x 33-10 / 3.261

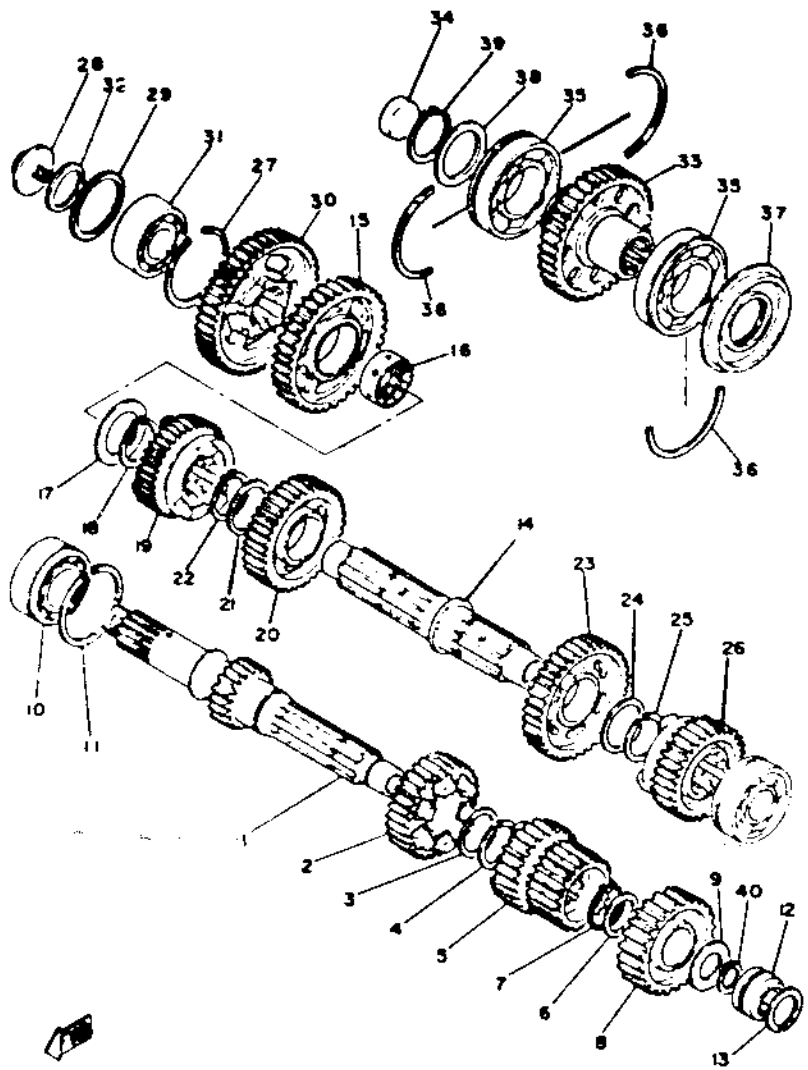

Ref. No.	Part Number	Description	Qty.
21	90201-30398-00	WASHER, plate	1
22	93410-30012-00	CIRCLIP	1
23	2H7-17221-01-00	GEAR, 2nd wheel (39T)	1
24	90201-30398-00	WASHER, plate	1
25	93440-30015-00	CIRCLIP	1
26	2H7-17251-00-00	GEAR, 5th wheel (30T)	1
27	93450-52010-00	CIRCLIP	1
28	90105-10085-00	BOLT, washer based	1
29	90201-252A4-00	WASHER, plate	1
30	2H7-17582-00-00	GEAR, middle drive (47T)	1
31	93304-20504-00	BEARING (93306-20533)	1
32	90387-443A8-00	COLLAR	1
33	2H7-17583-00-00	GEAR, middle driven (44T)	1
34	90331-27013-00	PLUG	1
35	93306-20705-00	BEARING (B0207N)	2
36	93440-72049-00	CIRCLIP	3
37	93103-35105-00	OIL SEAL	1
38	90201-35668-00	WASHER, plate	1
39	93410-35027-00	CIRCLIP	1
40	93410-20009-00	CIRCLIP	1